

DELPHI

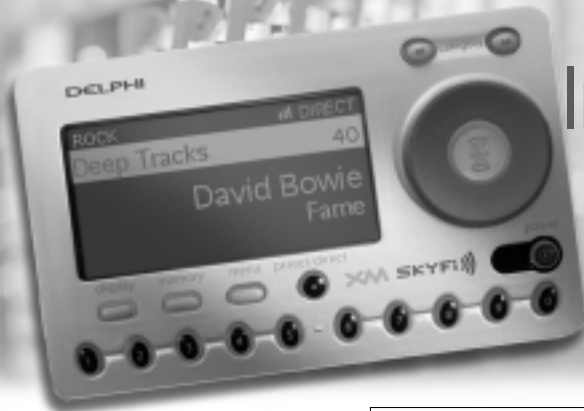

SKYFi™ Installation Guide

Home and Vehicle Kits

Contents:

SKYFi Home Kit Set-up	1
XM Home Antenna Set-up	3
SKYFi Vehicle Kit Set-up	7
SKYFi Car Cradle Installation	9
XM Vehicle Antenna Installation	14



Warning: This manual and the *SKYFi Operating Guide* contain important safety and operating information. Please read and follow the instructions in these manuals. Failure to do so could result in personal injury or damage to your SKYFi or to your vehicle.



Radio to the power of X™

SKYFi Home Kit Set-up

Your SKYFi™ Home Kit contains the following components:

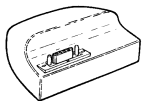

SKYFi Home Stand

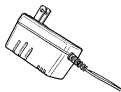

6V A/C power adaptor



XM® High-gain Home Antenna

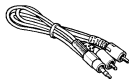

Audio cable

Set up your SKYFi Home Kit as follows:

1. Connect the ministereo (black connector) end of the supplied audio cable to the jack labeled "LINE OUT" on the back of the SKYFi Home Stand. Connect the red and white connectors to the input jacks on the audio equipment you want to use with SKYFi. Alternatively, you can connect a set of powered speakers directly to the SKYFi Home Stand by plugging the input cable supplied with the speakers directly into the "LINE OUT" jack.
2. Connect the XM Antenna to the jack labeled "ANT" on the back of the SKYFi Home Stand.
3. Connect the power adaptor to the connector labeled "DC IN 6V" on the SKYFi Home Stand.
4. Insert the SKYFi unit into the home stand and press the power button.

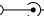

Caution: Connect only appropriate input devices to the SKYFi Home Stand jacks. Connecting an incorrect input device may damage the system and/or the external electronic device. It is recommended that you use only the A/C power adaptor that came with your SKYFi Home Kit. If you need to use a different adaptor, it must be a 6V, 1000mA DC adaptor and must contain a unified polarity-type jack, identified by the  symbol.

Note: See *SKYFi Operating Guide* for important user information.

Figure 1. SKYFi Home Kit components.

5. After powering up, if the display reads "ANTENNA," check that the antenna connection is secure and completely pushed in. Next, change channels (from 0 to 1 or from 1 to 0 if the receiver is not authorized yet). If the "ANTENNA" message remains, power down the radio, unplug the antenna, and look for any obvious damage. If no damage is detected, reconnect the antenna, turn the unit back on, and change channels again. If the message still appears, contact your retailer.

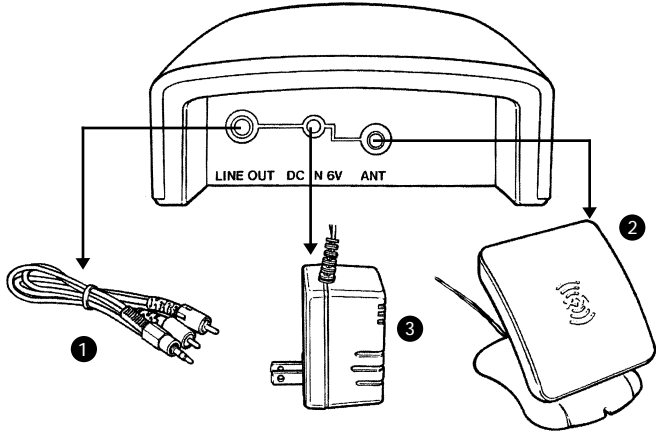

Figure 2. Connect accessories to your SKYFi Home Stand as shown.

XM Home Antenna Set-up

Aiming your XM Home Antenna

If the SKYFi display says “NO SIGNAL,” the antenna needs to be repositioned. In addition, even if you are receiving the XM signal, it is recommended that you optimize the position of your XM Antenna as described in this section enabling you to receive the strongest possible signal and consistent, mute-free reception.

Your SKYFi display has two different signal-strength indicators which will help you optimize the antenna’s position.

Basic signal-strength indicator

Your SKYFi Receiver has a basic signal-strength indicator visible at the top of the display screen during normal listening (figure 3). It has from zero to three vertical bars; three bars represent the strongest signal.

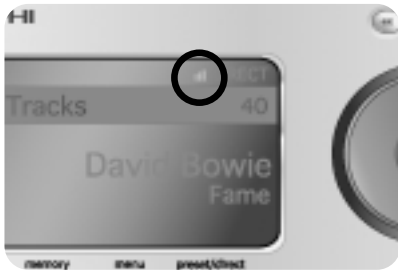

Figure 3. Use SKYFi's signal-strength meter to help with rough positioning of your XM Antenna and to see the signal strength during normal use.

Antenna Aiming signal-strength indicator

A higher-resolution signal-strength indicator screen is available to allow you to optimally aim your XM Antenna. To access and use this screen:

1. Press the menu button on the SKYFi Receiver and select the “Antenna Aiming” option. A screen similar to figure 4 will appear.
2. Adjust the antenna location until the maximum number of “SATELLITE” bars is filled in. SKYFi will receive programming as long as either the satellite or terrestrial signal has two bars filled in; selecting a position with the maximum number of “SATELLITE” bars displayed will ensure a consistently strong signal.

3. Press the menu button once to return to the menu screen. Press again to return to the normal play screen.

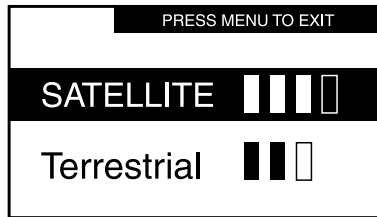

Figure 4. The "Antenna Aiming" function allows you to optimize position of your XM Antenna with this higher-resolution display screen.

Positioning the XM Antenna

The antenna that comes with the SKYFi Home Kit is a high-gain antenna that can receive XM's signal from one of XM's satellites and/or, depending on where you live, XM's terrestrial repeaters. It is recommended that the antenna be positioned near a south-facing window or outdoors with a clear view of the southeastern sky in order to receive the satellite signal. In some cases, it will be possible to receive XM's signal through standard home walls or a roof.

To position your antenna, first set up the home system as described earlier in this installation guide. Next, position the antenna until you receive the strongest possible satellite signal. If the satellite signal is not available, you can optimize it for a terrestrial signal (where available).

Indoor installation on a flat surface

To aim your antenna at the satellite:

1. Set antenna flat against its base on a flat (horizontal) surface.
2. Turn the base of the antenna so that the XM logo is facing to the south if you are in the eastern half of the U.S. and to the south/southeast if you are in the western half.
3. Use the "Antenna Aiming" screen, as described on page 3, to optimize antenna tilt angle and position.
5. If necessary, experiment with different locations near a south-facing window or outside.

Your antenna comes with 20 feet of cable. If that is not sufficient to locate the antenna where there is a strong XM signal, purchase

a 50-foot cable extension (Delphi model number SA10006) from your SKYFi retailer. Up to two extensions can be used together for up to 120 total feet of cable.

Outdoor installation or indoor wall mounting

The antenna can also be attached vertically to an external or internal wall if that is more convenient than placing it on a horizontal surface.

1. Holding your antenna up, find a wall location that ensures a strong signal. It is recommended that you use an extension cord to temporarily locate your SKYFi Home Stand outdoors while optimizing the antenna location with the "Antenna Aiming" screen.

2. Attach four screws to the wall using the screw-locator pattern in figure 5. Photocopy the pattern to use as a template. Use screws with head sizes small enough to fit in the center of each of the four holes but large enough not to pop out of the elongated sections. Leave 1/8 inch of the screw shanks behind the heads sticking out of the wall.
3. Tilt the antenna fully back on the base, place the antenna base on the four screw heads with the antenna pivot at the top, and pull down approximately 1/4 inch until the base is firmly secured. Note that the XM logo will be upside down when the antenna is properly installed.
4. Tilt the antenna away from the wall/base until the signal strength is optimized.

Note: Do not cut the antenna cable and attempt to splice it or attach alternative connectors or cable. The cable and connectors used in your SKYFi Home Kit are specially chosen and attached at the factory to ensure that they will work with XM's unique frequency band. Use an XM-approved extension kit (Delphi model number SA10006) with your SKYFi system. Failure to do so could damage the unit.

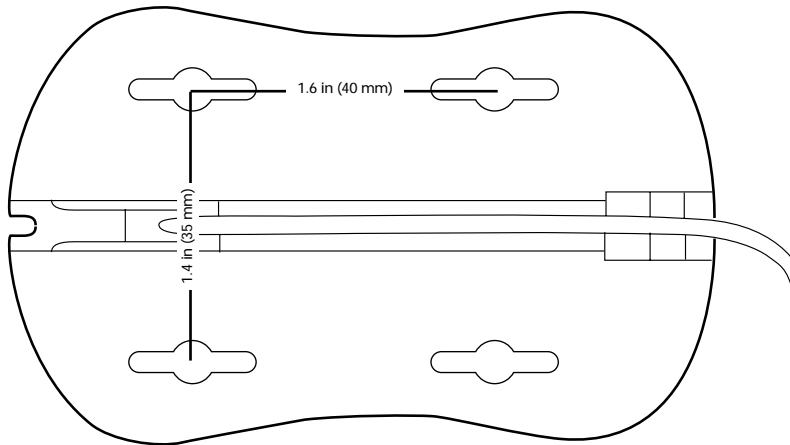
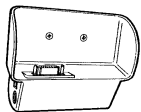

Figure 5. Photocopy this diagram of the screw-locator pattern on the bottom of your XM Antenna to use as a template for wall attachment.

SKYFi Vehicle Kit Set-up

Your SKYFi Vehicle Kit contains the following components:



SKYFi Car Cradle

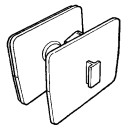

Car cradle mount



XM Vehicle Antenna

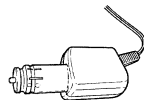

12V power adaptor

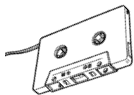

Cassette audio adaptor

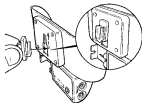

Nokia®-style button mount converter



Remote control visor clip kit

Your kit also includes:

- Extra adhesive pad
- Surface Preparation Cleaning Kit
- Alcohol Prep Pad

Figure 6. SKYFi Vehicle Kit components.

Hooking up your SKYFi Car Cradle

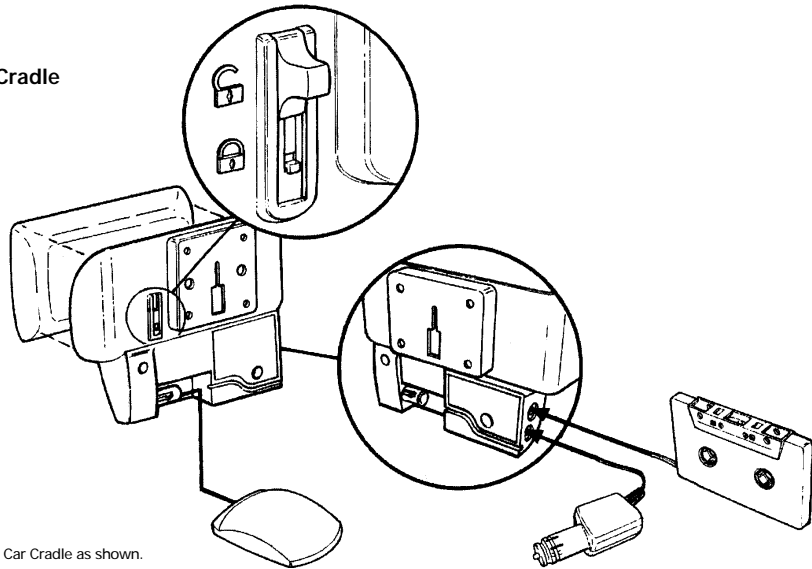

Figure 7. Connect accessories to your SKYFi Car Cradle as shown.

SKYFi Car Cradle Installation

Using the enclosed car cradle mount

Your SKYFi Vehicle Kit comes with a car cradle mount, which can be installed as follows:

1. First, attach all of the components as shown in figure 7 (page 8). Put your SKYFi Receiver into its car cradle and verify that the system is working. Disassemble the system, and proceed with step 2. When removing the antenna connector, be sure to push down on the tab marked "PUSH," and pull on the plastic connector directly (do NOT pull on cable).
2. Identify a hard, flat-as-possible surface within your car to allow the optimum SKYFi viewing position for the primary

user as well as access to the cassette player, power source, and antenna-cable route. In order to maximize visibility, this position should be chosen to minimize glare or direct sunlight on the display. Do not install the mount where it or SKYFi could block your vision, vehicle airbags, or controls. Do not install the mount on a leather surface. The adhesive used on the mount is not easily repositioned when installed, so please use care when choosing the location and placing the mount.



Warning: The SKYFi Receiver should be placed in your vehicle where it will not interfere with the function of safety features, e.g., deployment of airbags. Failure to correctly place the SKYFi Receiver may result in injury to you or others.

3. Clean the vehicle mounting surface with the enclosed Surface Preparation Cleaning Kit. Wipe with the towelette in only one direction. Do not wipe the surface in a circular motion or back and forth. Dry area with a clean, dry cloth. Wipe dry in the same direction again and then repeat this cleaning process. Allow to air dry thoroughly.
4. Clean the same surface with the enclosed Alcohol Prep Pad. Wipe in the same direction and manner as with the towelette. Dry the area with a clean, dry cloth, wiping in one direction. Allow to air dry thoroughly. Ensure that the surface is at least 60°F.

- 5. Warm the cradle mount adhesive pad by using a hair dryer or by placing the cradle mount on top of the vehicle's defrost outlet for several minutes with the heater on. Remove the liner from the adhesive pad and adhere to the vehicle's surface. Make sure you accurately place the pad on the first try since in many cases it will bond almost immediately. 3M recommends a 72-hour curing time for maximum adhesion.
- 6. Clip the SKYFi Car Cradle onto the car cradle mount.

You can also mount the SKYFi Car Cradle directly to your dashboard without using the car cradle mount by using the enclosed extra adhesive pad. Follow the prior mounting directions, and make sure you adhere the correct side of the pad to the car cradle as labeled.

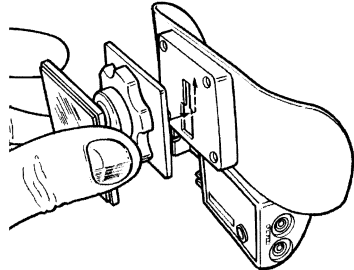

Figure 8. Attach car cradle mount to back of SKYFi Car Cradle as shown.

Removing car cradle mount from your dashboard

You can remove the car cradle mount from your dashboard by taking the following steps:

1. Lift one edge of the adhesive pad gently with fingers or the rounded edge of a spoon. Once enough of the edge is loosened to grip with your fingers, pull the pad gently from the mounting surface at a 90-degree angle. Avoid using sharp tools that could damage the car interior.

2. If the pad fails to loosen, first warm it with a hair dryer for 2 minutes to 3 minutes to soften the adhesive. Be careful not to apply too much heat, which could damage the mounting surface.



Caution: Never use a commercial heat gun or paint-stripping gun. This could result in damage to the unit or to your vehicle.

3. If any adhesive remains on the dashboard surface, the adhesive can easily be removed by rubbing your thumb or finger across it.

4. As necessary, apply a silicon coating, such as Armor All® protectant, to the dashboard surface in order to restore its shine.

Using other third-party mounts

The SKYFi Car Cradle is also designed to work with many different styles of readily available third-party cell phone, PDA, GPS, and other mounts. These will provide an almost infinite number of mounting options to suit any car interior. If you use one of these mounts, follow the installation instructions that come with the mount and install the SKYFi Car Cradle as follows:

- **Belkin® air vent style mounts.** The SKYFi Car Cradle will attach directly to Belkin brand air vent style phone mounts.

- **Nokia-style button mounts.** Use the Nokia-style button mount converter included in the SKYFi Vehicle Kit to convert the back of the car cradle to work with hands-free mounts designed to work with button (Nokia-style) mounts, such as the Pro.Fit® UltiMount™. Make sure that any mount you purchase has clearance for the SKYFi Car Cradle to hang from the button mount.

- **AMPS-compatible mounts.** The back of the SKYFi Car Cradle has a four-hole pattern that allows it to be connected to any AMPS-compatible mount. To use this feature, remove the two screws in the back of the car cradle that secure the back plate. Attach the back plate to the AMPS-compatible mount using four screws (not included). Reattach the back plate to the car cradle.



Caution: Be sure to route the power cord, antenna cord, and adaptor/modulator cord away from vehicle pedals and controls so that they will not interfere with your ability to control the vehicle. Failure to do so may compromise operation of the vehicle.



Caution: Connect only appropriate input devices to the SKYFi Car Cradle jacks. Connecting an incorrect input device may damage the system and/or the external electronic device.

- **Custom brackets.** Pro.Fit International Vehicle Specific Mounts™ (VSMs) are available for most vehicle types to give your installation a more integrated look. The VSMs are custom designed to be attached using existing hardware within your vehicle.

The SKYFi Car Cradle can be attached to the VSM using the AMPS hole pattern on the back of the cradle as previously described. Detailed installation instructions come with each VSM. Learn more about these and other Pro.Fit brackets optimized for SKYFi at www.pro-fit-intl.com/xmradio or by calling 1-800-388-0073. Overnight shipping is available for orders received by 3 p.m. Central Standard Time.

Installing the visor clip on your SKYFi Remote Control

Your SKYFi Vehicle Kit comes with a visor clip to allow you to conveniently keep your remote control clipped to your sun visor. Install this clip by sliding the battery door off of the remote control, sliding the clip in as shown in figure 9, and then installing the new battery door that came with the clip.

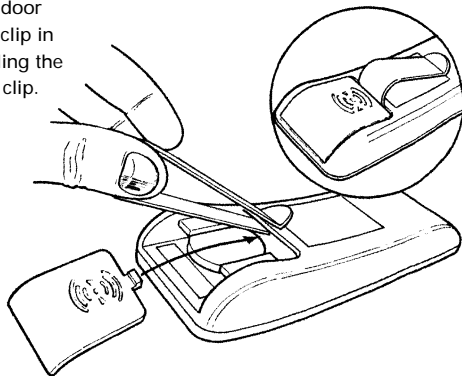

Figure 9. Attach the visor clip to your SKYFi Remote Control as shown.

XM Vehicle Antenna Installation

Pre-installation signal check



Caution: Installation of the XM Vehicle Antenna may require special tools as well as knowledge of vehicle mechanical procedures. If you are not comfortable with or are unsure of these procedures, please seek the services of a professional car audio installer.

- Before starting, make sure SKYFi is not docked in its cradle.
- On the antenna cable, locate the end connector. **Note: Before making a connection, make sure the lead on the SKYFi Car Cradle and connector at the end of the antenna cable is free and clear of debris.**
- Firmly push the end connector of the antenna cable into the corresponding color-coded connector on the cradle until the connector clicks.
- Temporarily mount the antenna on top of your vehicle (make sure the vehicle surface is clean to prevent scratching it).
- Re-dock SKYFi in its cradle. With power connected, check to see if you are receiving a signal and that no error messages are displayed.
- If you do not receive a signal or the display reads "NO SIGNAL," it may be because you are inside a building or in an area where the signal is blocked. Move the vehicle to another location.
- If you are receiving an "ANTENNA" error message, do the following:
 1. Turn SKYFi off, wait 10 seconds, then turn back on.
 2. Recheck antenna connection.
 3. Inspect the cable to ensure it is not crimped, cut, or otherwise damaged.
 4. If these actions do not have any effect, please contact your retailer.

Positioning and pre-application

- The antenna must be mounted on a conductive (metal) surface of at least 2 square feet. A minimum distance of 5 inches should be kept from the molding of the rear window.

- The antenna should always be mounted outside, on the highest location of your vehicle (roof/cab). **Never mount the antenna inside the passenger compartment.** Figure 10 shows three typical mounting locations.

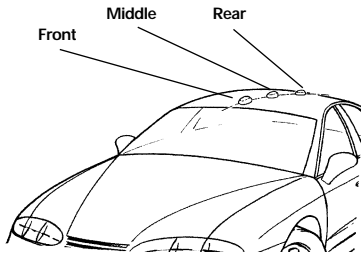

Figure 10. The design flexibility of your XM Vehicle Antenna allows mounting on many types of vehicles. Trunk mounting of the antenna is an alternative for hard- or soft-top convertibles with nonmetallic rooftops.

- Position the antenna in such a way that it will be free of mechanical (outward-opening moon roof) and line-of-sight obstructions such as roof racks, luggage boxes, etc. In these instances, it may be advantageous to consider positioning the antenna offset from the vehicle centerline.
- Trunk mounting of the antenna is an alternative for hard- or soft-top convertibles with nonmetallic rooftops.

- Once you have a desired antenna location, plan how to route the cable from this location to the receiver, avoiding blocked passages and any obstructions that could kink, crimp, twist, or chafe the cable. If the cable will come into contact with a rough metal opening, use a rubber grommet to prevent damage.
- To ease routing of the cable, the antenna connector may be removed by pushing down on the tab marked "PUSH" and pulling on the connector (do NOT pull on the cables).
- Use pre-existing wiring channels created by the vehicle manufacturer whenever feasible.

Final installation

1. Verify that the antenna is in its final desired position. The antenna contains a powerful magnet that will secure the antenna to a metal roof under normal driving conditions. If desired, the extra adhesive pad included in the SKYFi Vehicle Kit can be used to create a more permanent mount. Follow the surface preparation instructions on pages 9 and 10. The antenna can also be mounted on a nonmetallic roof using the adhesive pad, but you will experience a slight reduction in performance without a metal mounting surface.



Caution: Refrain from using food or drinks near the SKYFi Receiver. Spilling food or drinks into the unit could damage it.

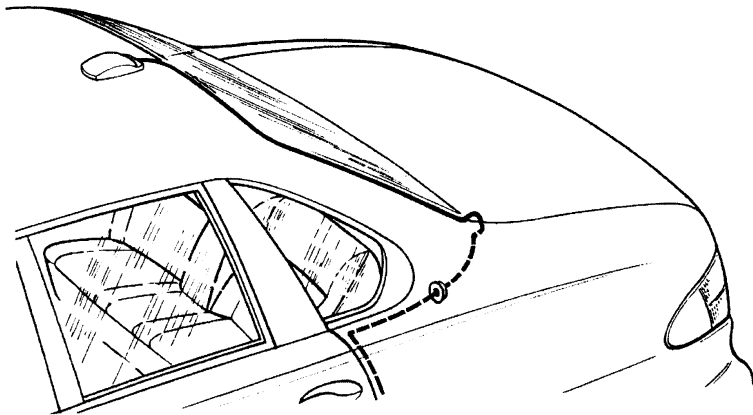

Figure 11. Route XM Vehicle Antenna wiring as shown.

2. Begin routing the wiring from the antenna toward the receiver.
3. Work the antenna cable under the rear-window molding. Heating the molding may help if it is hard.
4. Make adjustments and take up slack where necessary. If additional cable length is needed, purchase a TERK® XM 15-foot cable extension kit (TERK model # TRK-SREXT).
5. When you reach the SKYFi Car Cradle, verify that the connector is clear of obstruction, and that the cable is not kinked, crimped, or chafed. Reconnect the antenna and receiver leads. (If you have removed the antenna connector, reconnect this first.)
6. Slide the SKYFi Receiver into the car cradle until you feel the connector click. Push down on the locking tab in back in order to firmly lock your SKYFi in place while driving.

This device complies with part 15 of the FCC Rules. Operation is subject to the following two conditions: (1) This device may not cause harmful interference, and (2) this device must accept any interference received, including interference that may cause undesired operation.

Changes or modifications not expressly approved by Delphi could void the user's authority to operate this equipment.

DELPHI

Delphi Corporation
1441 West Long Lake Road
Troy, Michigan 48098-5090
U.S.A.
Customer Service: [1] 877.GO DELPHI

www.delphi.com

The SKYFI name, XM name, and related logos
are trademarks of XM Satellite Radio Inc.